

SDC0FF0I

PCI Express Industrial I/O Control Board

16-ch Isolated Digital Input

16-ch Isolated Digital Output



Introduction

SUNIX SDC0FF0I, industrial isolated digital I/O PCI-Express add-on card, is designed for PC-based IoT Gateway or desktop that enables data acquisition and I/O controls in industrial automation. This board built-in SUNIX Digital-I/O controller, **QiuNiu**, and also built with many of SUNIX advanced features and technologies. In addition, SUNIX provides API software and SDK library, allowing users to program under Windows 10/11 and Linux operating systems. The software package includes a dynamic library.dll, C, C# and Python programming language sample code, making it easier to develop application software. SUNIX SDC0FF0I board enriches digital I/O expandable capacity with cost-efficient design; it is the best digital I/O control solution for lite-industrial applications.

Features

- Designed to meet PCI Express Base Specification Revision 2.1.
- With high reliable SUNIX **QiuNiu** Digital-I/O controller.
- Plug-n-Play, I/O address and IRQ assigned by system.
- Ultra low power consumption (<1.5W) design for green environment and industrial application.
- High quality electronic components, low impedance and high stability ensure product quality and reliability.
- Support Microsoft Windows 10/11 and Linux with C, C# and Python programming language sample code.
- Capable of engaging with EdgeX device C SDK for EdgeX service development.
- Certified by CE, FCC, RoHS, and Microsoft approvals.
- Support both standard and Low profile bracket design to meet various of PC chassis.

Digital I/O Interfaces:

- Expands isolated sixteen (16) digital input channels with features for all channels.
 - Support both NPN & PNP devices
 - Support both dry and wet contact connections
 - With digital filter for noise reduction
 - Built-in 32-bit counter for all digital in channels
- Expands isolated sixteen (16) NPN type digital output channels with initial value (Bootling & Restart) protection.
- Each channel built-in 2.5KV isolation protection for signal and power, allowing the input signals to be completely floated so as to prevent ground loops.

Specifications

Board Level

Interface	PCI Express
Controller	SUNIX QiuNiu Digital-I/O controller
BUS	PCI Express Gen1 x 1 (single Lane)
IRQ & IO	Assigned by System
ESD Protection	±15KV IEC61000-4-2 Air Gap Discharge ±8KV IEC61000-4-2 Contact Discharge

Digital Input

Type	NPN & PNP	Channel	16-channel
Dry Contact	Logic Level 0: Open; Logic Level 1: Close to GND	Wet Contact	Logic Level 0: 0 to 3VDC; Logic Level 1: 10 to 50VDC
Input Resistance	10KΩ	Isolation	2500 VDC
Counter	32-bit counter on all channel	Frequency	Input Range 2KHz max.
Digital Filter	Digital filter for noise reduction	Pin Define	DI1~DI16, COM, GND
Interrupt Mode	Event trigger (Rising Edge, Falling Edge, Both modes) & polling for all channels		
PCB Connector	DB44 Female connector		

Digital Output

Type	NPN	Channel	16-channel
Voltage Range	3.5 to 40VDC	Current	500mA per Channel
Isolation	2500 VDC	Pin Define	DO1~DO16, PWR, GND
Initial Protection	Load preset output value automatically during booting and restart		
PCB Connector	DB44 Female connector		

Software Support

OS	Windows 10 (X86/X64), Windows 11, Linux
SDK	Library: Supporting C, C++, C# and Python languages. C, C# and Python sample code available
Third Party Software support	Capable of engaging with EdgeX device C SDK for EdgeX service development.

Declaration

Green Product	RoHS, WEEE
----------------------	------------

Regulatory Approvals

Hardware	CE / FCC / VCCI / BSMI
-----------------	------------------------

Environment

Operation Temperature	-20 to 70°C (-4 to 158°F)
Operation Humidity	5 to 95% (non-condensing)
Storage Temperature	-20 to 70°C (-4 to 158°F)

Dimension

PCB Dimension	120 x 68.5 mm
Bracket	Standard 120 mm / Low Profile 79.2mm
Bracket Space	1

Unit : mm

Standard bracket

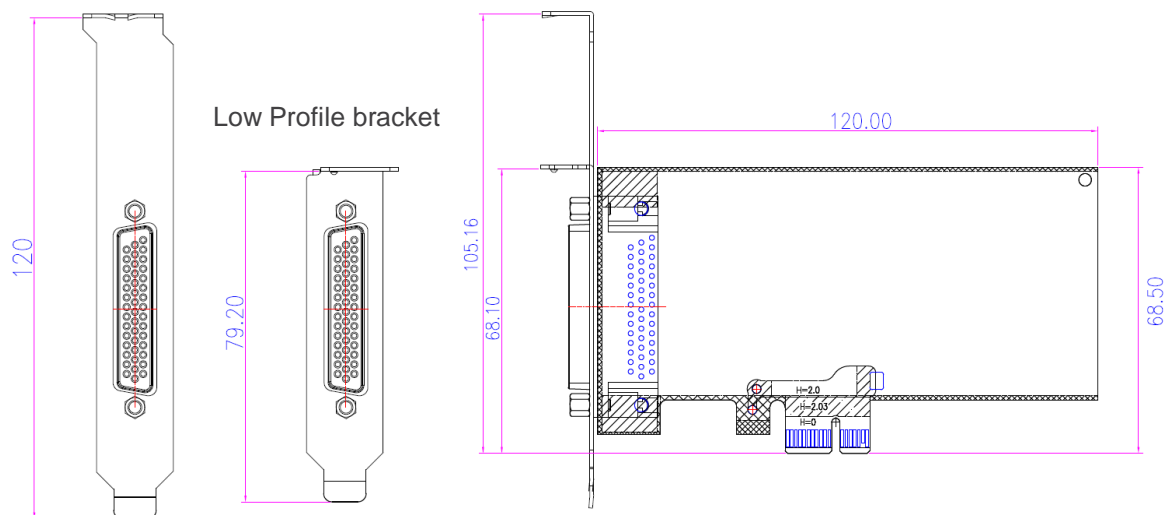

Package

- SDC0FF0I PCI Express Industrial I/O Control Board
- DB44 Male to Female connection cable, 100cm
- DB44 Male DIN-rail wiring board
- Low Profile Bracket
- Quick Installation Guide

Pin Assignment

■ Digital Input / Output

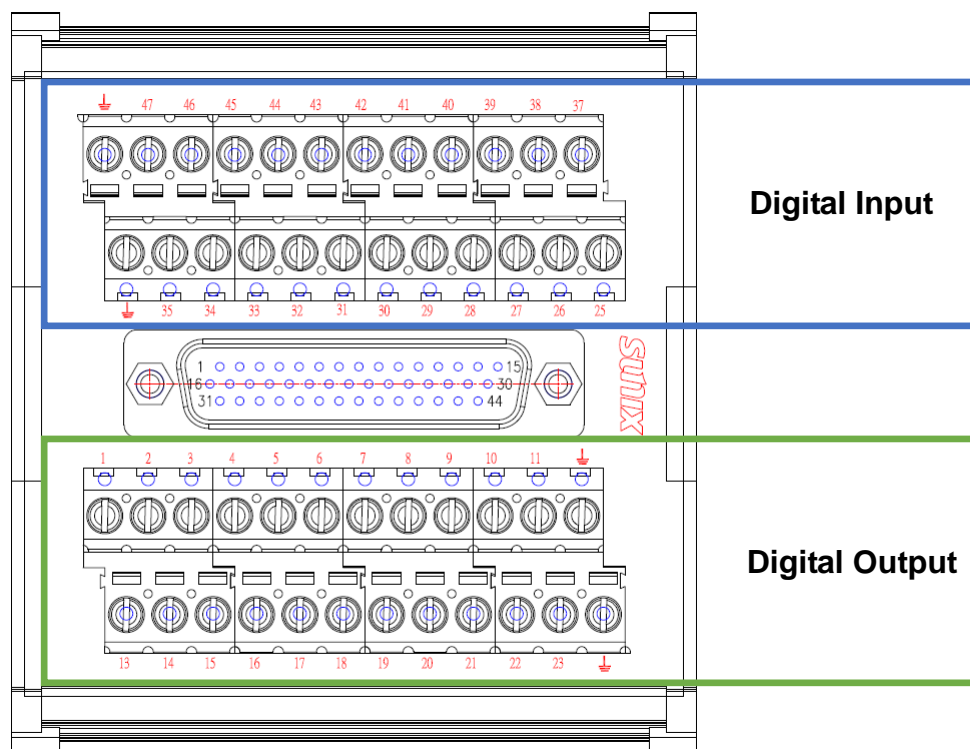

PIN	Digital Output	PIN	Digital Output	PIN	Digital Input	PIN	Digital Input
1	DO_COM1	13	DO GND1	25	DI COM1	37	DI GND1
2	DO_COM2	14	DO GND2	26	DI COM2	38	DI GND2
3	DO_COM3	15	DO GND3	27	DI COM3	39	DI GND3
4	DO 1	16	DO 9	28	DI 1	40	DI 9
5	DO 2	17	DO 10	29	DI 2	41	DI 10
6	DO 3	18	DO 11	30	DI 4	42	DI 11
7	DO 4	19	DO 12	31	DI 5	43	DI 12
8	DO 5	20	DO 13	32	DI 5	44	DI 13
9	DO 6	21	DO 14	33	DI 6	45	DI 14
10	DO 7	22	DO 15	34	DI 7	46	DI 15
11	DO 8	23	DO 16	35	DI 8	47	DI 16
⏏	GND	⏏	GND	⏏	GND	⏏	GND

Accessories

- DB44 Male to Female connection cable
- 100 cm

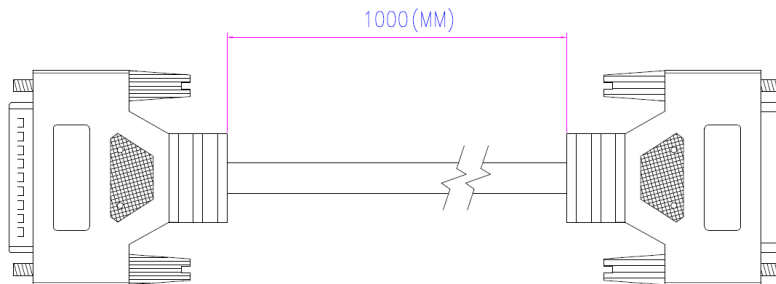

- DB44 Male DIN-rail wiring board
- 79.1 x 85.5 mm

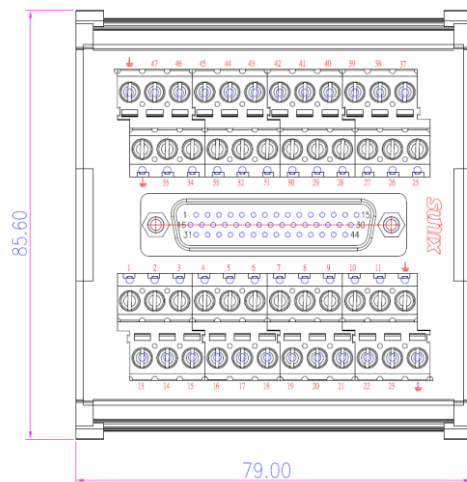

- Low Profile Bracket

